

NOTES

The copyright of this drawing is held by Lea Hough & Co
Chartered Surveyors LLP.

Do not scale from this drawing. All dimensions are approximate
and must be checked and verified by the contractor prior to
works commencing on site.

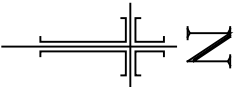

REVISIONS		
REV	DESCRIPTION	DATE

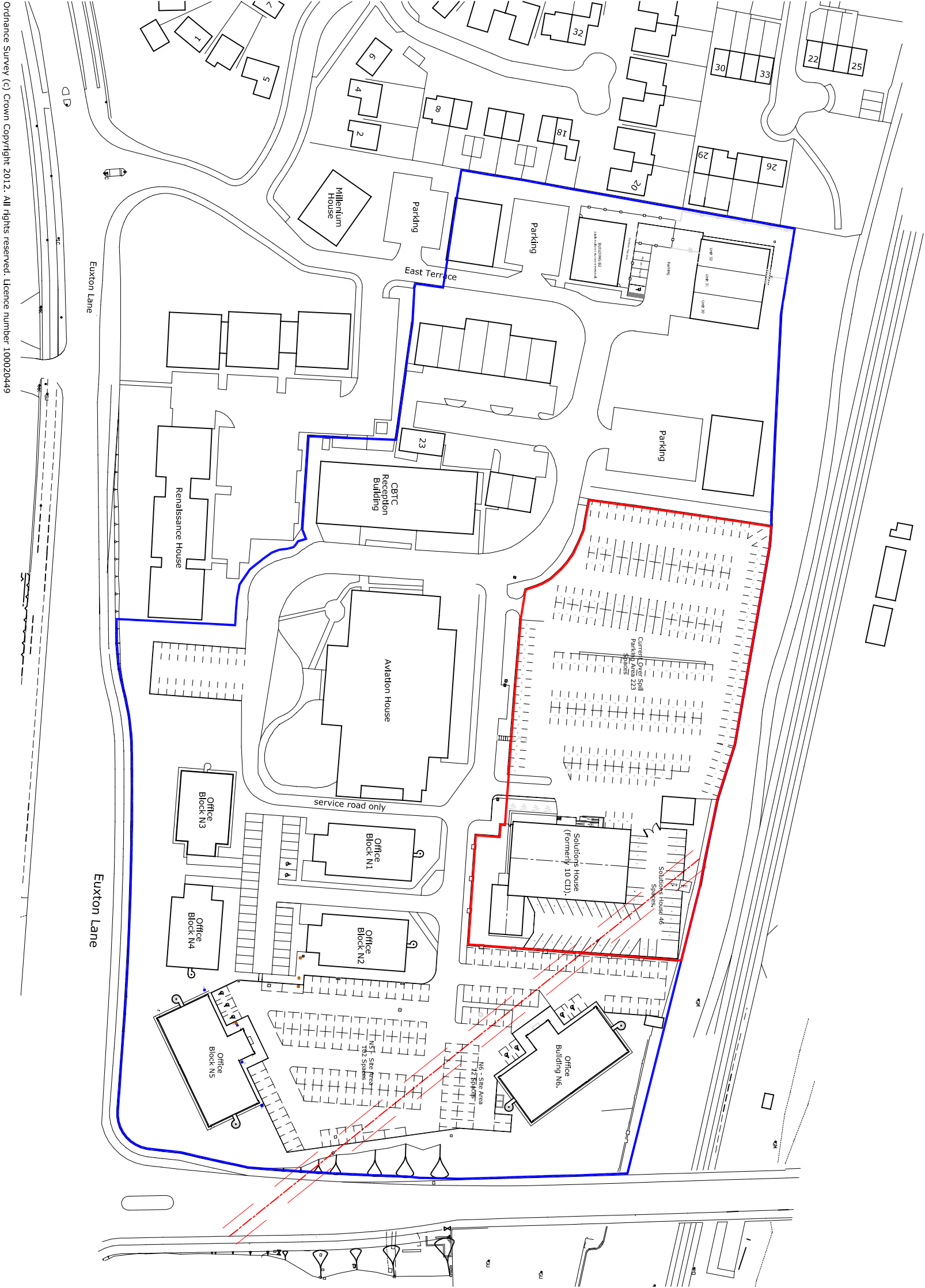

Ordnance Survey (c) Crown Copyright 2012. All rights reserved. Licence number 100020449



LeaHough

CHARTERED SURVEYORS

Survey Valuation Design Planning Sales

Blakewater House
Phoenix Business Park
Blakewater Road
Blackburn
Lancashire
BB1 5RW
Tel: 01 254 2601 96
Email: info@leahough.co.uk
Web: www.leahough.co.uk

8 Eaton Avenue
Matrix Office Park
Buckshaw Village
Preston
Lancashire
PR7 7NA
Tel: 01 772 458866

CLIENT:
Mr Julian Hindle
Chorley Business & Technology Centre,
Euxton Lane, Euxton,
Chorley.
PR7 6TE

PROJECT ADDRESS:
Chorley Business & Technology Park,
Euxton Lane,
Euxton
Chorley.
PR7 6TE

PROJECT TITLE:
Proposed New Office Block (N7), Demolition of
Solutions House & Reconfiguration of Car Park.

DRAWING TITLE:
Site Location Plan

PAPER SIZE: A3	DRAWING NUMBER: BS.15-121(A)/01	REV -
SCALE: 1:1250	DATE: October 2017	DRAWN BY GM